

Extended Range

Ancon[®] Wall Ties

for use with
Cellular Clay Blocks

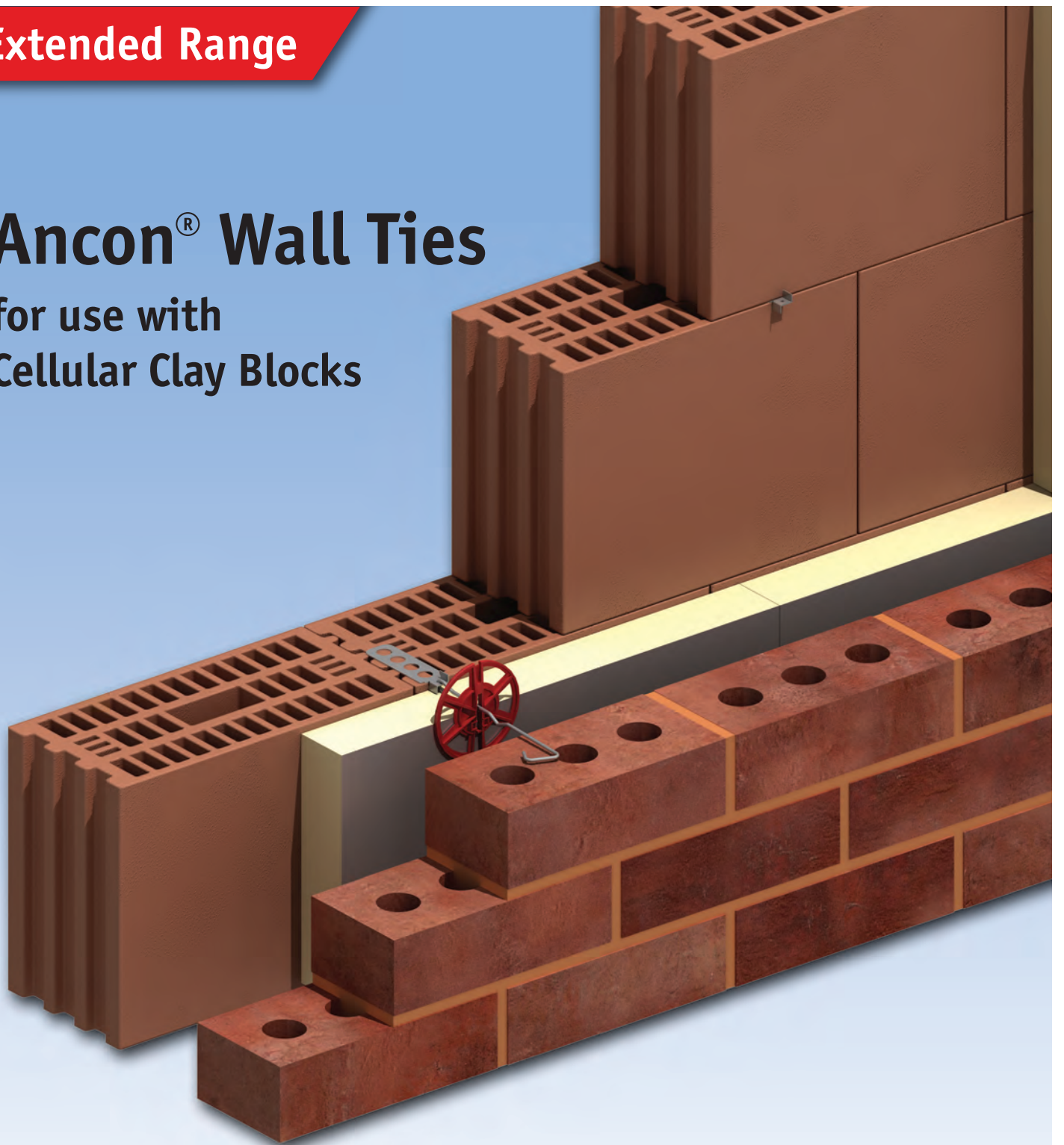

Developed for use with the Porothersm System

 **Porothersm**

Ancon[®]
BUILDING PRODUCTS

Wall Ties

for use with Cellular Clay Blockwork

Ancon has developed an innovative range of wall ties for use with cellular clay blockwork, where the horizontal bed joints are just 1mm. The range includes ties for internal wall junctions and internal/external cavity walls. They are manufactured from corrosion-resistant stainless steel and are suitable for use in housing and commercial applications.

Brick-to-Block Cavity Walls

Ancon CCB3 and CCB4

Two-part wall ties to connect external brick to internal cellular clay block.

Installation is phased which eliminates any danger of injury from wall ties projecting from a part built cavity wall. For complete information on tie types refer to PD6697: 2011 or contact Ancon.

Cavity: 100-150mm



Type 3

CCB3-100

CCB3-125

Type 4

CCB4-100

CCB4-125

CCB4-150

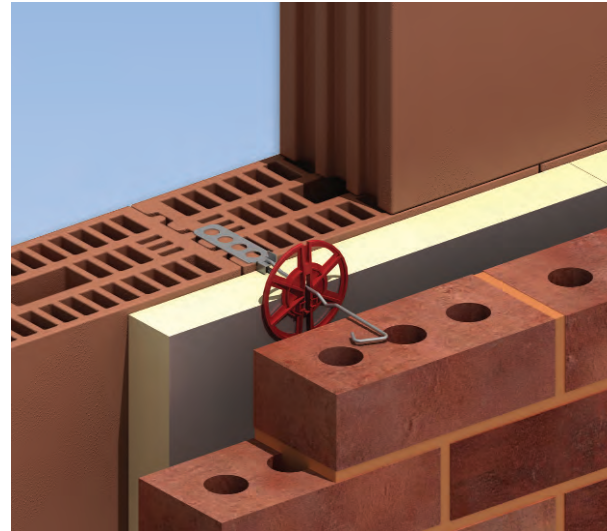

CCB3 and CCB4 Wall Ties

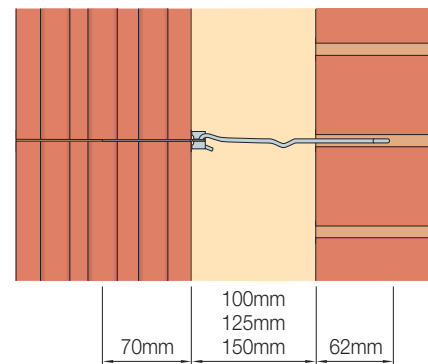

Cellular Clay Block Cavity Walls

Ancon CCB-JJ for External Walls

One-part wall tie for use in external walls where both leaves are constructed from cellular clay block.

Cavity: 50-200mm

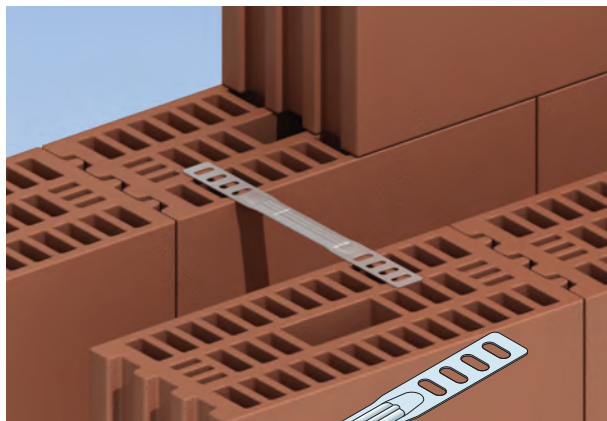

Ancon CCBA for Internal Walls

Three-part wall tie for use in internal separating (party) walls where both leaves are constructed from cellular clay block.

Cavity: 75mm, 100mm

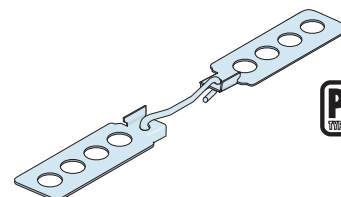
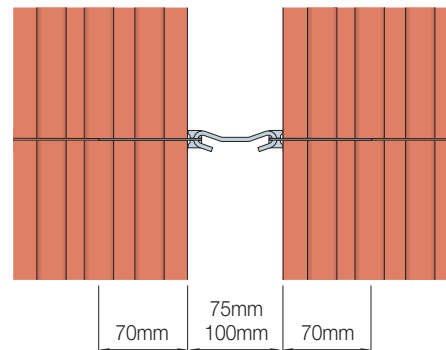

Internal Wall Junctions

Ancon CCB-IWJ-180

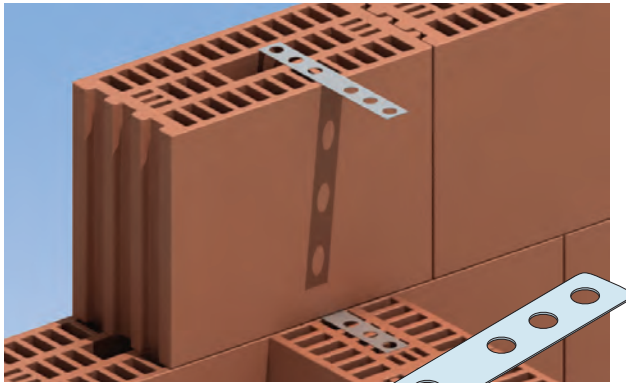

Flat tie for connecting perimeter walls to internal walls

Standard Length: 180mm

Note: For block widths greater than 140mm, two ties should be used per course



Ancon CCB-L200



Abutment tie for connecting perimeter walls to dividing walls

Standard Length: 130mm



Ancon CCB-SMJ-200

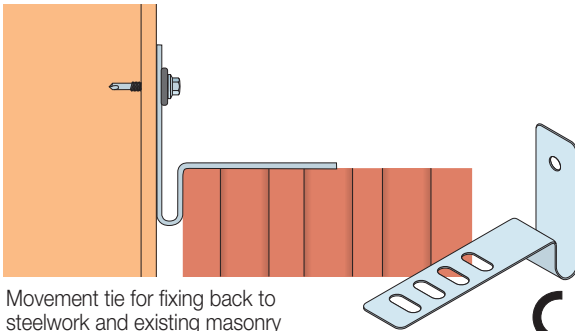

Movement tie for fixing back to steelwork and existing masonry

Standard Length: 110mm



Ancon CCB-TMJ-200

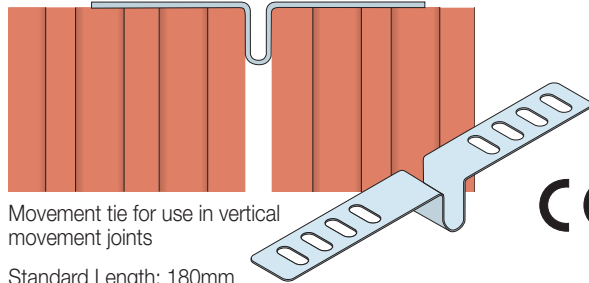

Movement tie for use in vertical movement joints

Standard Length: 180mm



Windposts for Cellular Clay Blockwork

Ancon Windposts are designed to span vertically between floors to provide lateral support for panels of brickwork. A range of wall ties is available to suit Ancon windposts when used with an inner leaf of cellular clay blocks.

The CCB-SPN connects channel profile posts to the inner cellular clay block leaf and CCB-SNS ties are used across angle shaped posts installed in the inner leaf.

Ancon WP1/3 Channel Windpost

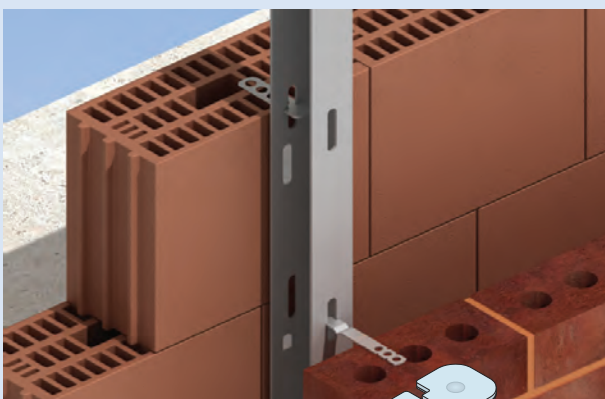

One way windpost tie

CCB-SPN

Ancon WP2 Angle Windpost

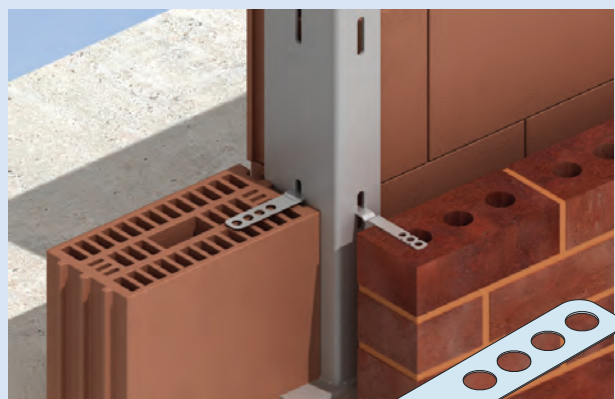

Two way windpost tie

CCB-SNS



Ancon Building Products
President Way, President Park
Sheffield S4 7UR
United Kingdom
Tel: +44 (0) 114 275 5224
Fax: +44 (0) 114 276 8543
Email: info@ancon.co.uk
Visit: www.ancon.co.uk
Follow on Twitter: @AnconUK

Ancon (Middle East) FZE
PO Box 17225
Jebel Ali
Dubai
United Arab Emirates
Tel: +971 (0) 4 883 4346
Fax: +971 (0) 4 883 4347
Email: info@ancon.ae
Visit: www.ancon.ae

Ancon Building Products
98 Kurrajong Avenue
Mount Druitt
Sydney
NSW 2770
Australia
Tel: +61 (0) 2 8808 3100
Fax: +61 (0) 2 9675 3390
Email: info@ancon.com.au
Visit: www.ancon.com.au

Ancon Building Products
2/19 Nuttall Drive
Hillsborough
Christchurch 8022
New Zealand
Tel: +64 (0) 3 376 5205
Fax: +63 (0) 3 376 5206
Email: info@ancon.co.nz
Visit: www.ancon.co.nz

Ancon (Schweiz) AG
Gewerbezone Widalmi 10
3216 Ried bei Kerzers
Switzerland
Tel: +41 (0) 31 750 3030
Fax: +41 (0) 31 750 3033
Email: info@ancon.ch
Visit: www.ancon.ch

**Ancon Building Products
GesmbH**
Puchgasse 1
A-1220 Vienna
Austria
Tel: +43 (0) 1 259 58 62-0
Fax: +43 (0) 1 259 58 62-40
Email: info@ancon.at
Visit: www.ancon.at

Ancon GmbH
Bartholomäusstrasse 26
90489 Nuremberg
Germany
Tel: +49 (0) 911 955 1234 0
Fax: +49 (0) 911 955 1234 9
Email: info@anconbp.de
Visit: www.anconbp.de



These products are available from:

© Ancon Building Products 2014

The construction applications and details provided in this literature are indicative only. In every case, project working details should be entrusted to appropriately qualified and experienced persons.

Whilst every care has been exercised in the preparation of this document to ensure that any advice, recommendations or information is accurate, no liability or responsibility of any kind is accepted in respect of Ancon Building Products.

With a policy of continuous product development Ancon Building Products reserves the right to modify product design and specification without due notice.



Porotherm is a Wienerberger brand, is a registered trade mark and is used with permission from Wienerberger Limited

Wall Ties

for use with Cellular Clay Blockwork

Cavity Wall Ties

To tie external brick to internal cellular clay block
Cavity: 100-150mm

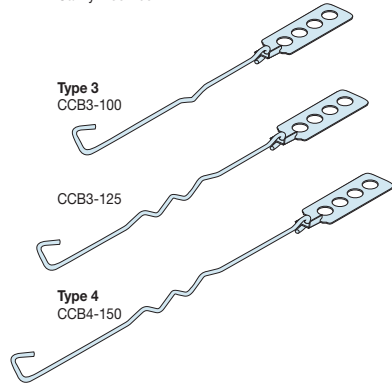

CCB3 and CCB4 Wall Ties

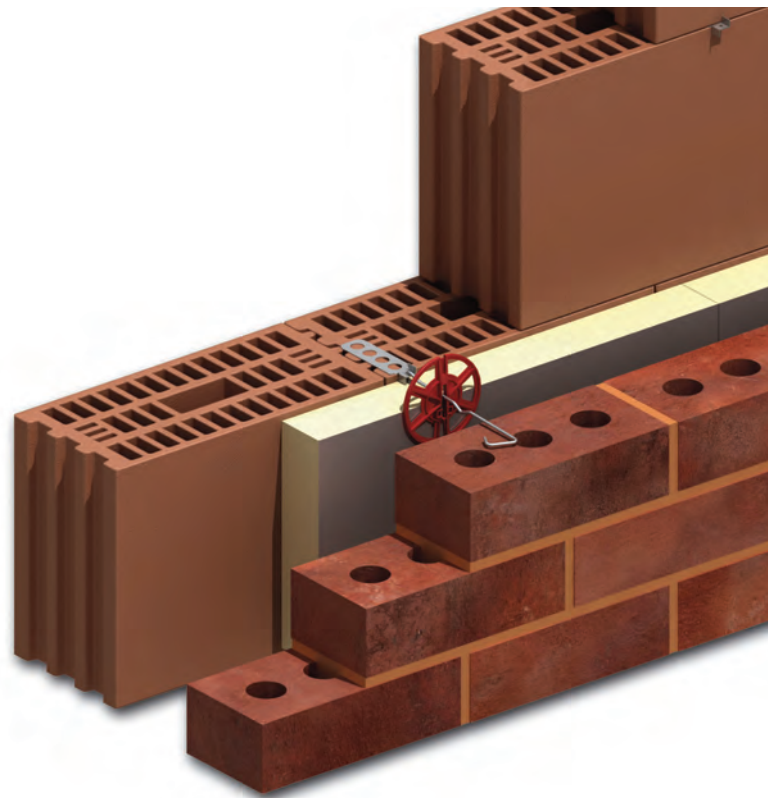
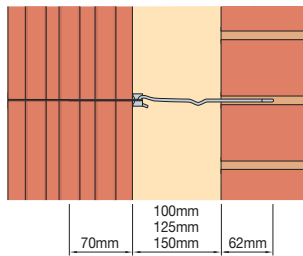

Windpost Ties for Cellular Clay Blockwork

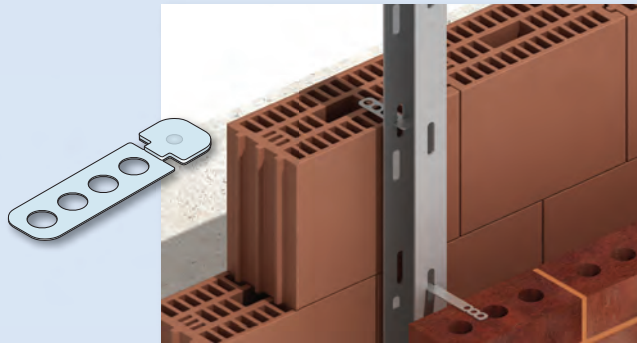

Ancon CCB-SPN Tie
One way windpost tie

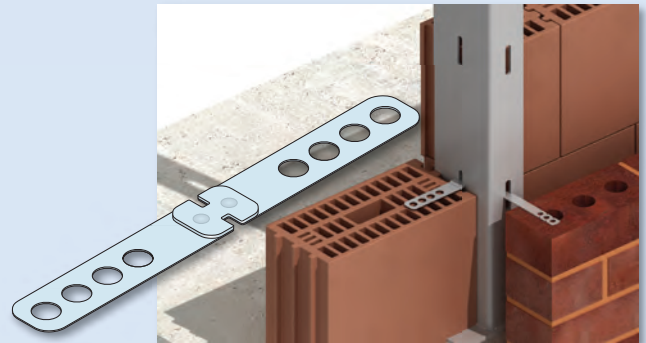

Ancon CCB-SNS Tie
Two way windpost tie

Internal Separating Cavity Walls

Cavity: 75mm, 100mm

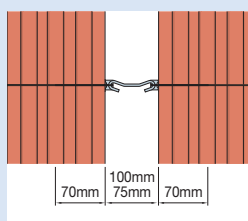
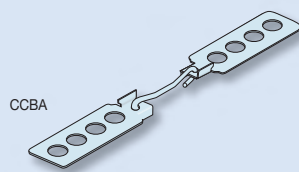

Internal Wall Junctions

Length: 180mm

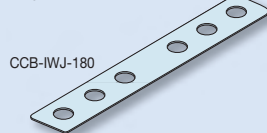

Ties for Internal Wall Junctions

Other ties in the range

Ancon CCB-JJ

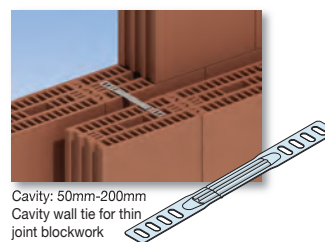

Cavity: 50mm-200mm
Cavity wall tie for thin joint blockwork

Ancon CCB-TMJ-200

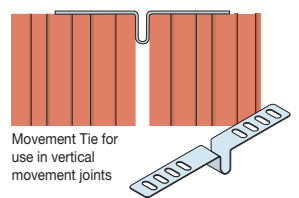

Movement Tie for use in vertical movement joints

Ancon CCB-L200

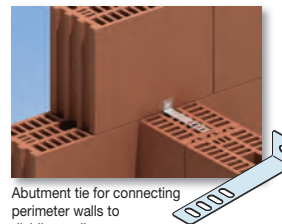

Abutment tie for connecting perimeter walls to dividing walls

Ancon CCB-SMJ-200

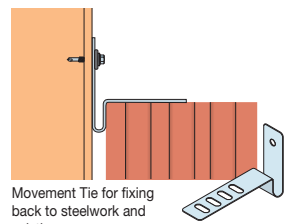

Movement Tie for fixing back to steelwork and existing masonry

Developed for use with the Porotherm System

